

4

3

2

1

D

D

C

C

B

B

A

A

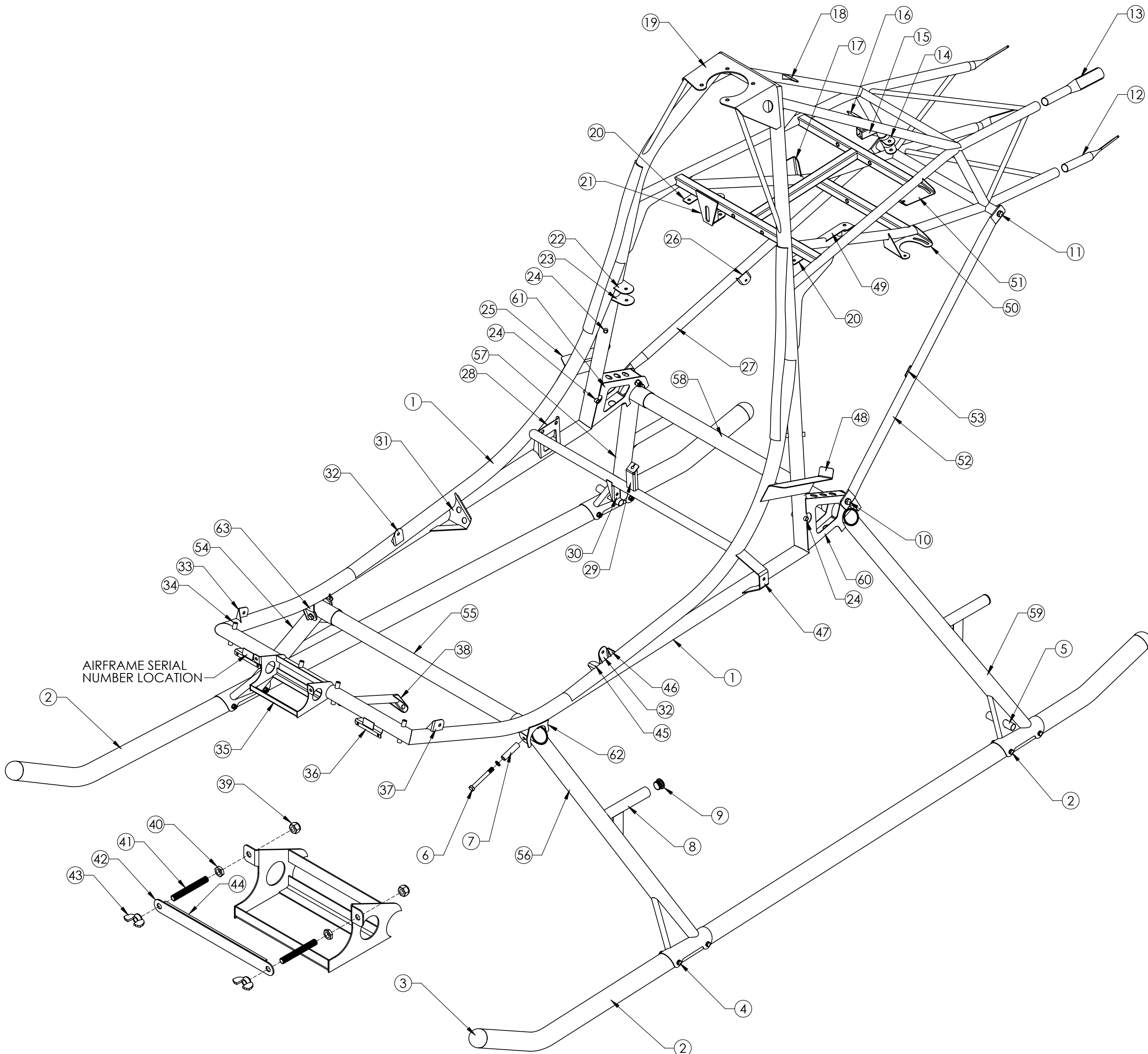

REF.	PART NO.	PART NAME	QTY.
1	E10-8001	AIRFRAME, A600	1
2	E11-8200	SKID TUBE ASSEMBLY	2
3	E11-8250	SKID END PLUG	4
4	E00-2416	BOLT AN4-25A 1/4 X 2-5/8	8
	E00-3402	NUT AN365-428A 1/4-28 FIBERLOCK	8
	E00-4401	WASHER AN960-416 (1/4 REGULAR)	16
5	E37-9020	BUSHING, GROUND HANDLING WHEELS	2
6	E00-2610	BOLT AN6-31A 3/8 X 3-1/8	4
	E00-3600	NUT AN365-624A 3/8-24 FIBERLOCK	4
	E00-4600	WASHER AN960-616 3/8 REGULAR	8
7	E11-7430	LANDING GEAR PIVOT BUSHING	4
8	E11-7240	LANDING GEAR STEP	4
9	E11-4111	STEP END PLUG	4
10	E00-2604	BOLT AN6-24A 3/8 X 2-1/2	2
	E00-3600	NUT AN365-624A 3/8-24 FIBERLOCK	2
	E00-4600	WASHER AN960-616 3/8 REGULAR	4
11	E00-2606	BOLT, 3/8-16 X 1 DRILLED HEAD	2
	E00-4600	WASHER AN960-616 3/8 REGULAR	2
12	E09-3231	TAIL BOOM ATTACHMENT BRACKET, LOWER	2
13	E09-3221	TAIL BOOM ATTACHMENT BRACKET, UPPER	2
14	E18-5140	TAIL ROTOR BELT TENSIONER MOUNT	1
15	E10-6210	ALTERNATOR MOUNT	1
16	E12-3650	SURGE TANK BRACKET, PILOT	1
17	E12-8150	WATER PUMP BRACKET	1
18	E12-3660	SURGE TANK BRACKET, PASSENGER	1
19	E12-3411	HOOD BRACKET	1
20	E12-8170	SEAT BELT ATTACHMENT BRACKET	2
21	E12-3800	CLUTCH IDLER ARM BRACKET	1
22	E12-3191	TORQUE LINK BRACKET, UPPER	1
23	E12-3192	TORQUE LINK BRACKET, LOWER	1
24	E10-1010	ENGINE MOUNT BUSHING	4
25	E12-3611	FUEL TANK BRACKET, PASSENGER	1
26	E12-3640	RADIATOR MOUNTING BKT, PASSENGER	1
27	E10-3247	TAIL BOOM SUPPORT BRACE, PASSENGER	1
28	E12-34xx	OIL FILTER BRACKET	1
29	E12-3500	THROTTLE CABLE BRACKET	1
30	E12-3160	INSIDE COLLECTIVE SHAFT BRACKET	1
31	E12-3151	CYCLIC FORE & AFT CABLE BRACKET	1
32	E12-3130	CYCLIC SHAFT BRACKET	2
33	E12-3131	PEDAL SHAFT BRACKET, PASSENGER	1
34	E10-6230	BODY SUPPORT BUSHING	4
35	E12-8100	BATTERY BOX	1
36	E12-3100	FOOT PEDAL SCISSOR BRACKET	2
37	E12-3131	PEDAL SHAFT BRACKET, PILOT	1
38	E12-3320	TAIL ROTOR CONTROL CABLE BRACKET	1
39	E00-3504	NUT AN365-518 5/16-18 FIBERLOCK	2
40	E00-3503	NUT AN340-518 5/16-18 JAM	2
41	E10-4010	5/16-18 STUD (CUT TO LENGTH)	2
42	E10-4022	BATTERY STRAP .063 X 3/4	1
43	E00-3505	NUT 5/16-18 WING	2
44	E10-4031	BATTERY RUBBER STRIP	1
45	E12-3141	CYCLIC STOP BRACKET, FORE	1
46	E12-3142	CYCLIC STOP BRACKET, AFT	1
47	E12-3170	OUTSIDE COLLECTIVE SHAFT BRACKET	1
48	E12-3601	FUEL TANK BRACKET, PILOT	1
49	E12-3231	CLUTCH PIVOT ARM BRACKET	1
50	E12-3271	FAN DRIVE COUNTERSHAFT BKT, LOWER	1
51	E12-3261	FAN DRIVE COUNTERSHAFT BKT, UPPER	1
52	E10-3242	TAIL BOOM SUPPORT BRACE, PILOT	1
53	E12-3645	RADIATOR MOUNTING BRACKET, PILOT	1
54	E11-7020	FRONT LEG TUBE WELDMENT, PASSENGER	1
55	E11-7410	SPRING TUBE, FRONT LANDING GEAR	1
56	E11-7010	FRONT LEG TUBE WELDMENT, PILOT	1
57	E11-7040	REAR LEG TUBE WELDMENT, PASSENGER	1
58	E11-7420	SPRING TUBE, REAR LANDING GEAR	1
59	E11-7030	REAR LEG TUBE WELDMENT, PILOT	1
60	E10-3510	REAR LANDING GEAR BRACKET, PILOT	1
61	E10-3520	REAR LANDING GEAR BRACKET, PASS.	1
62	E10-3610	FRONT LANDING GEAR BRACKET, PILOT	1
63	E11-7030	FRONT LANDING GEAR BRACKET, PASS.	1

DRAWN		NAME	DATE	
CHECK		WAR	6/14/2019	
ENG		-	-	
MFG		-	-	
O.A.		-	-	TITLE:
				AIRFRAME, LANDING GEAR
<small>PROPRIETARY AND CONFIDENTIAL THE INFORMATION CONTAINED IN THIS DRAWING IS THE SOLE PROPERTY OF ROTORWAY HELICOPTER MANUFACTURING CO. ANY REPRODUCTION IN PART OR AS A WHOLE WITHOUT THE WRITTEN PERMISSION OF ROTORWAY HELICOPTER MANUFACTURING CO. IS PROHIBITED.</small>				SIZE DWG. NO. REV <b>C</b> E10-2000 <b>B</b>
				SHT 1 OF 1

4

3

2

1